



# HYDRA series

## AIO 240 / 360

### MANUAL DE UTILIZARE USER MANUAL

RO / EN

#### MULTUMIM!

**RO** Va multumim ca ati ales sistemul de racire cu lichid All-In-One pentru procesor AQIRYS Hydra. Seria Hydra ofera performante de racire excelente pentru procesor, inclusiv capacitate adecvata pentru a face fata parametrilor normali de overlocking, totul frumos completat de o pompa si ventilatoare cu iluminare ARGB.

**EN** Thank you for choosing the AQIRYS Hydra All-In-One CPU liquid cooling system. The Hydra series delivers excellent all-around cooling performance for your CPU, including adequate capacity to cope with normal overlocking parameters, all beautifully complemented by brilliant ARGB illuminated pump and fans.

#### THANK YOU!

Please take a moment and carefully read this manual before installing your new liquid cooling system.

#### Accesorii incluse

#### Included accessories

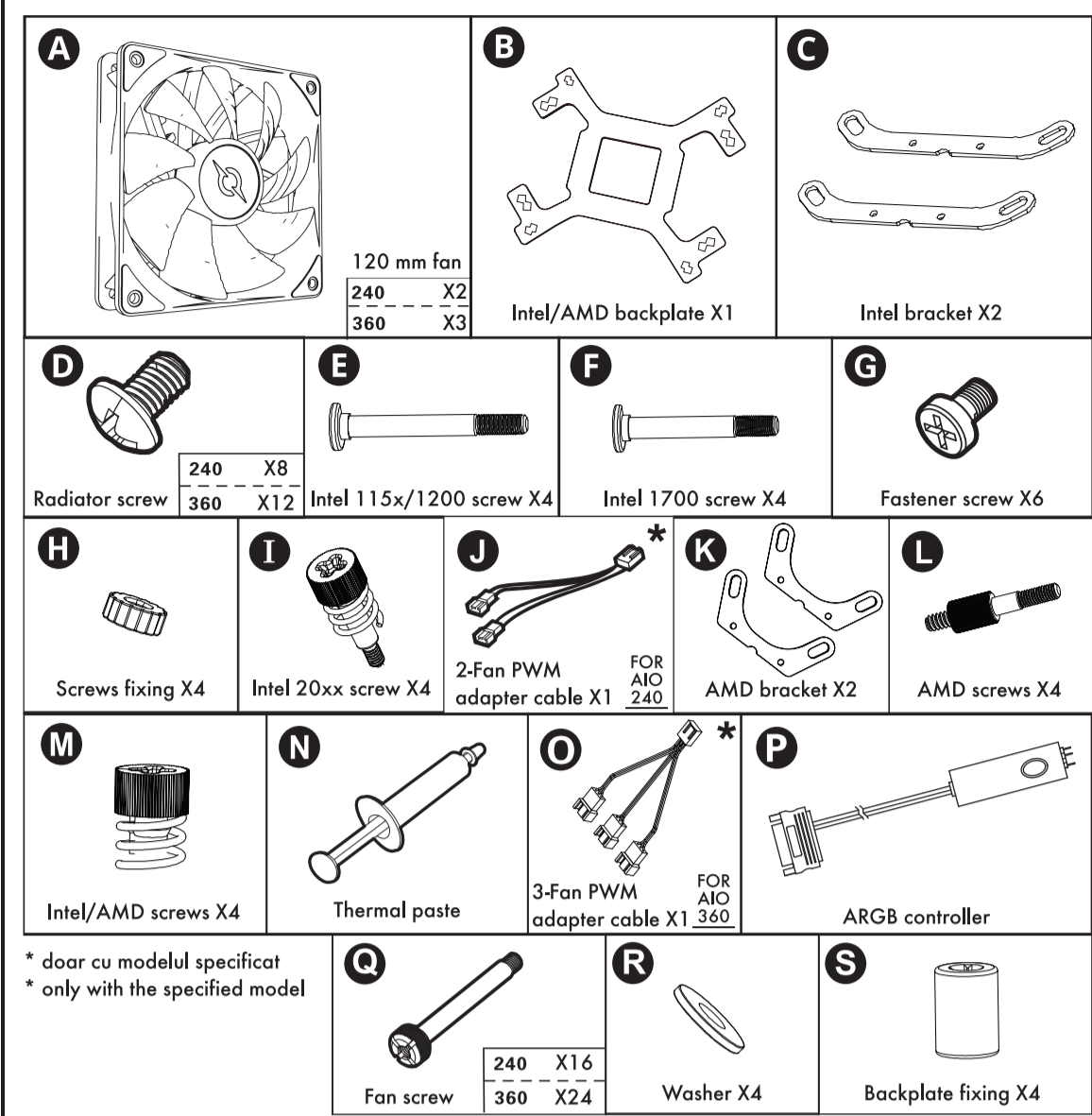

\* doar cu modelul specificat  
\* only with the specified model

#### ATENIE!

#### WARNING!

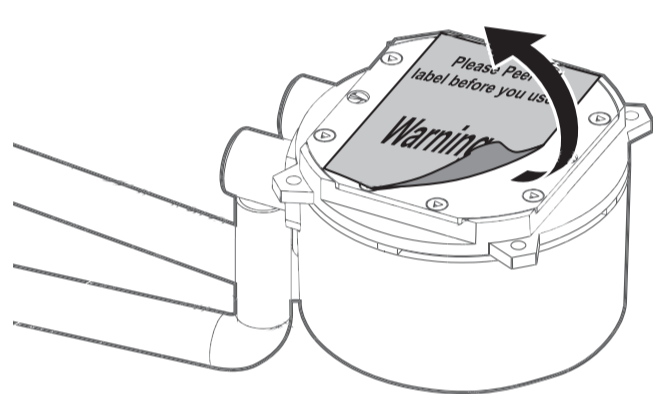

**RO** Baza pompei este acoperita cu o folie protectoare. Indepartati folia inainte de instalare!

**EN** The base of the pump is covered with a protective foil. Remove the foil before installation!

**RO** Aplicati pasta termoconductoare (N) pe suprafata procesorului inainte de a instala pompa. Pentru o eficienta maxima in transferul termic, se recomanda aplicarea pastei in forma de X pe procesor. Aceasta metoda asigura o distributie uniforma a pastei odata ce pompa este montata si presata. Inainte de aplicare, asigurati-va ca ati indepartat orice urme de pasta termoconductoare veche de pe suprafata procesorului. Este important sa nu aplicati pasta termoconductoare in exces, deoarece acest lucru poate afecta performanta de racire.

**EN** Apply the thermal paste (N) to the surface of the processor before installing the pump. For maximum efficiency in thermal transfer, it is recommended to apply the paste in the shape of an X on the processor. This method ensures even distribution of the paste once the pump is mounted and pressed down. Before applying, make sure to remove any traces of old thermal paste from the processor's surface. It is important not to apply the thermal paste excessively, as this can impact the cooling performance.

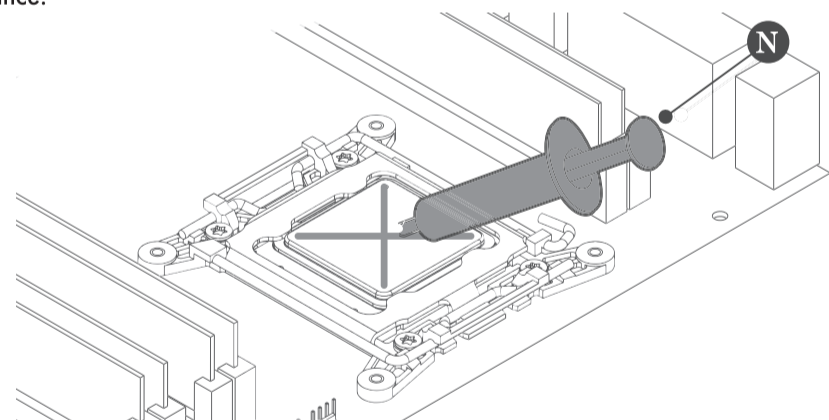

#### Montarea ventilatoarelor

#### Fans installation

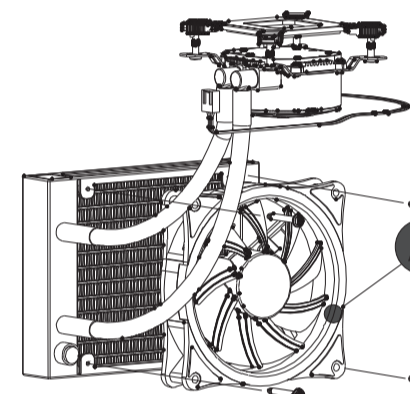

**RO** Atasati ventilatoarele la radiator folosind suruburile (Q). Recomandam pozitionarea si instalarea ventilatoarelor astfel incat fluxul de aer generat sa introduca aer rece din exterior prin radiator.

**EN** Attach the fans to the radiator using the screws (Q). We recommend the positioning and installation of the fans so that the generated airflow will introduce cold air from outside through the radiator.

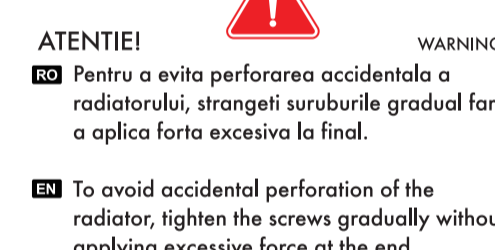
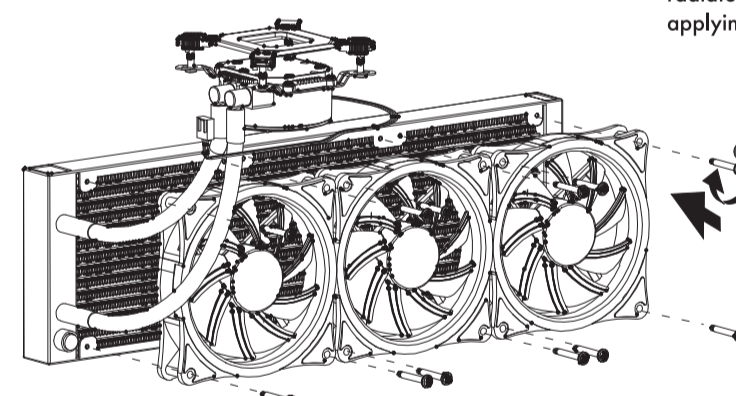
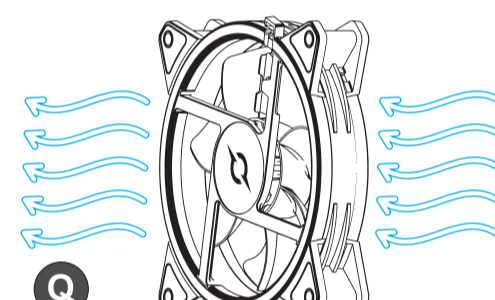
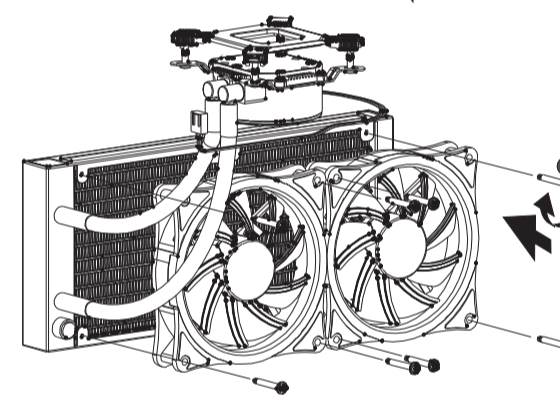

#### ATENIE!

**RO** Pentru a evita perforarea accidentala a radiatorului, strangeti suruburile gradual fara a aplica forta excesiva la final.

**EN** To avoid accidental perforation of the radiator, tighten the screws gradually without applying excessive force at the end.

#### Instalarea radiatorului

#### Radiator installation

**RO** Pentru a evita introducerea aerului din circuit in pompa si a obtine performante optime si o functionare in parametri normali, va rugam sa instalati radiatorul respectand imaginile alaturate. Instalati radiatorul in carcasa folosind suruburile (D). Pentru a evita perforarea accidentala a radiatorului, strangeti suruburile gradual fara a aplica forta excesiva la final.

**EN** To avoid the influx of air from the circuit into the pump and achieve optimal performances and operation within parameters, please install the radiator respecting the adjacent images. Install the radiator in the case using the screws (D). To avoid accidental perforation of the radiator, tighten the screws gradually without applying excessive force at the end.

#### Recomandat

#### Recommended

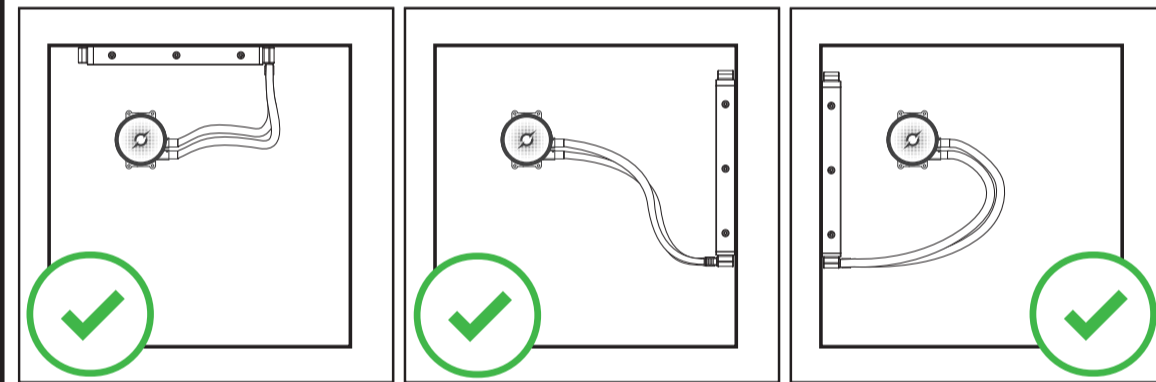

#### ATENIE!

#### WARNING!

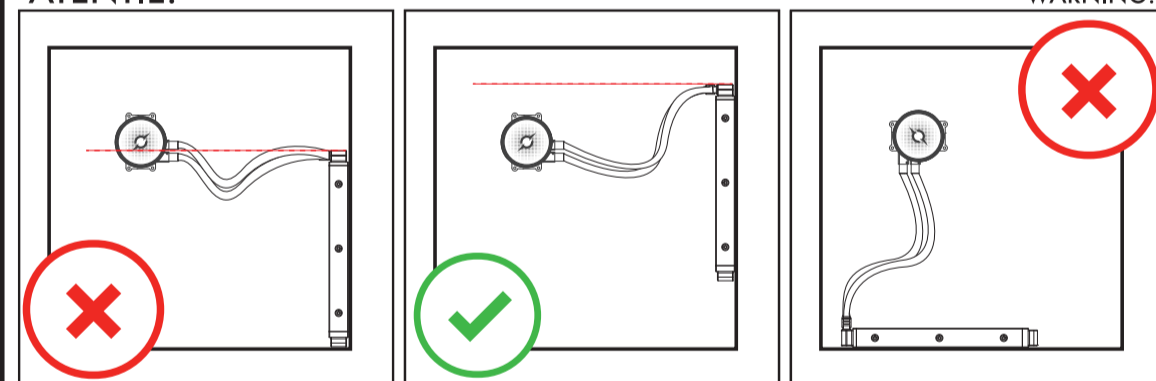

#### Instalarea pompei - INTEL

#### Pump installation - INTEL

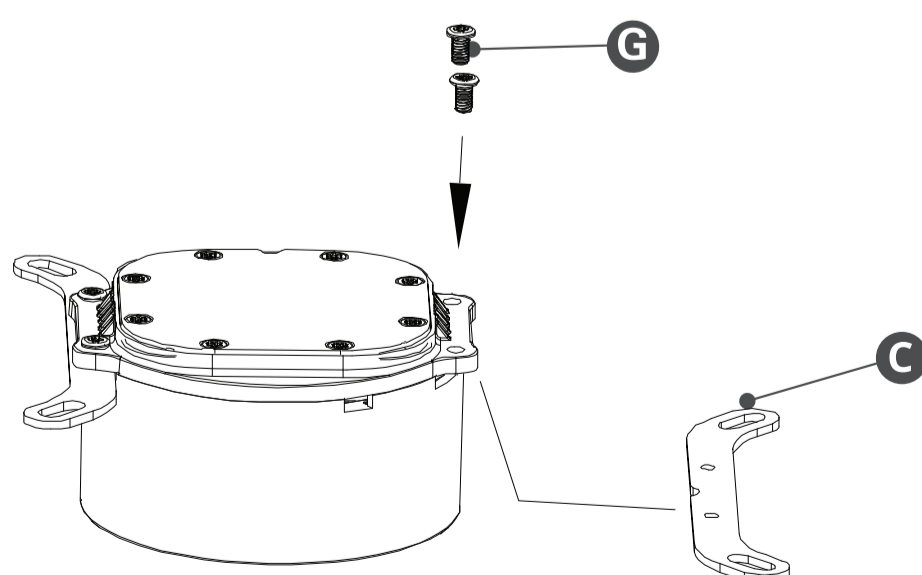

**RO** Atasati clemele Intel (C) la pompa folosind suruburile (G) si respectand pozitionarea din imagine.

**EN** Attach the Intel fasteners (C) to the pump using the screws (G) and following the positioning in the image.

#### Instalarea pompei - INTEL (115x/1200/1700)

#### Pump installation - INTEL (115x/1200/1700)

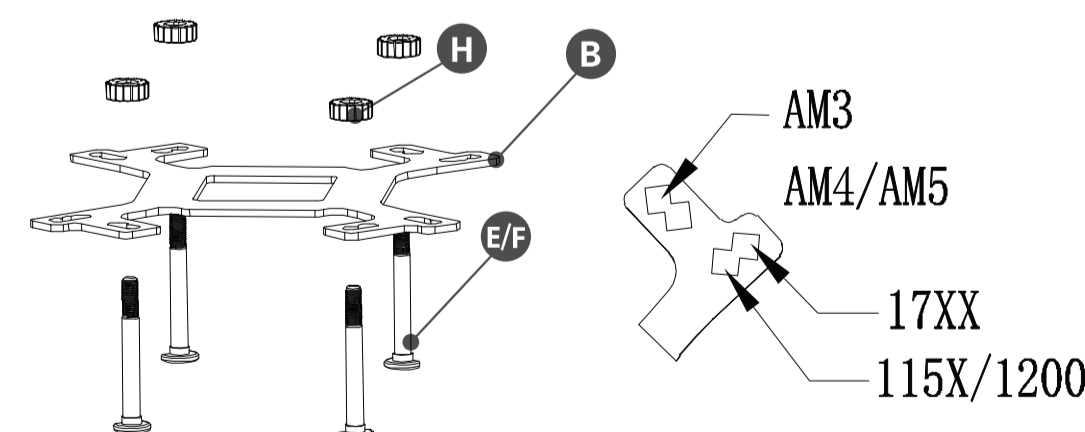

**RO** Configurati backplate-ul (B) pentru soclul de procesor corespunzator, pozitionand toate cele patru suruburi in locul destinat (pentru socket 1700, 115x, 1200).

**EN** Set up the backplate (B) for the corresponding processor socket, positioning all four screws in the designated place (for socket 1700, 115x, 1200).

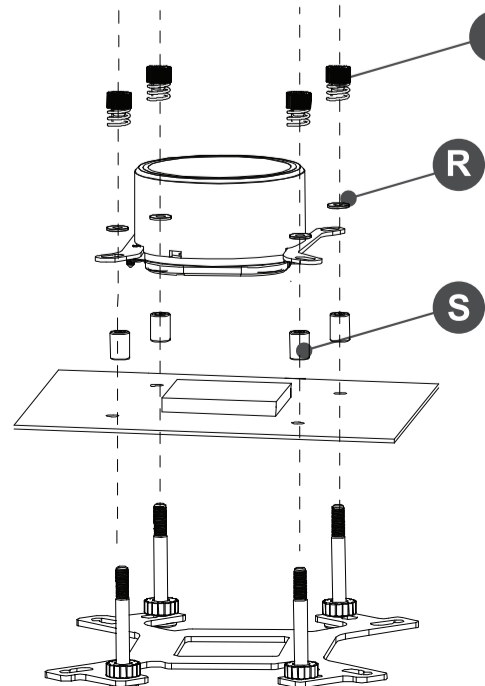

**RO** Instalati pompa si fixati-o de backplate folosind suruburile (E) pentru socket 115x/1200 sau (F) pentru socket 1700. Inainte de a incepe fixarea pompei, nu uitati sa montati distantierul (S) si saiba (R) pentru a asigura montajul corect si stabil al pompei. Strangeti pe rand si gradual suruburile (M) opuse (in diagonala) fara a utiliza forta excesiva la final.

**EN** Install the pump and secure it to the backplate using screws (E) for socket 115x/1200 or (F) for socket 1700. Before beginning the pump installation, do not forget to install the spacer (S) and washer (R) to ensure the correct and stable mounting of the pump. Tighten the opposite screws (M) gradually and in turn (diagonally) without applying excessive force at the end.

#### Instalarea pompei - INTEL (20xx)

#### Pump installation - INTEL (20xx)

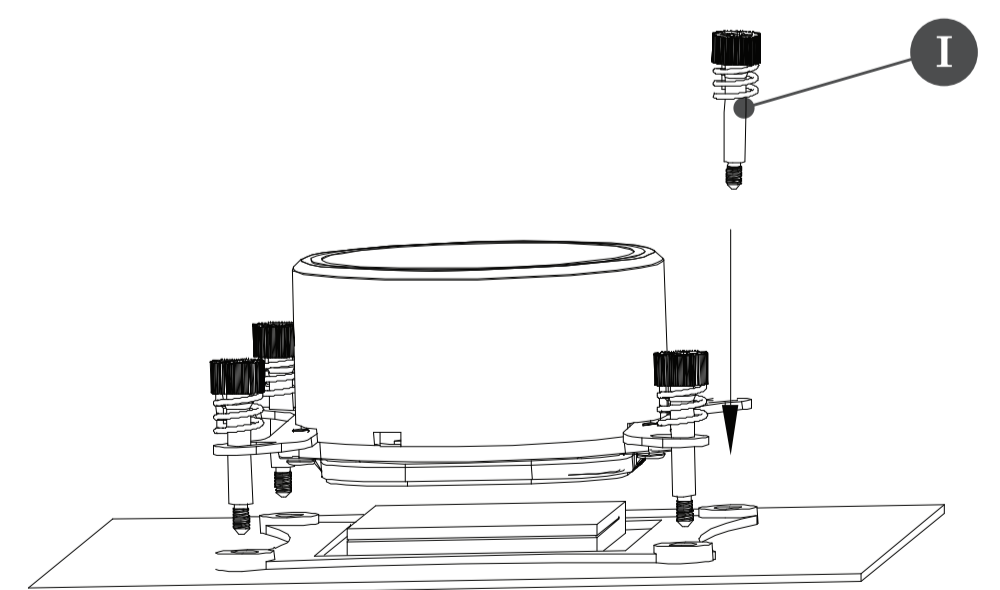

**RO** Instalati pompa si fixati-o de sistemul de prindere Intel folosind suruburile (I) pentru socket 20xx. Strangeti pe rand si gradual suruburile opuse (in diagonala) fara a utiliza forta excesiva la final.

**EN** Install the pump and secure it to the Intel mounting system using the 20xx socket screws (I). Tighten the opposite screws (diagonally) one at a time and gradually without using excessive force at the end.

**Instalarea pompei - AMD**

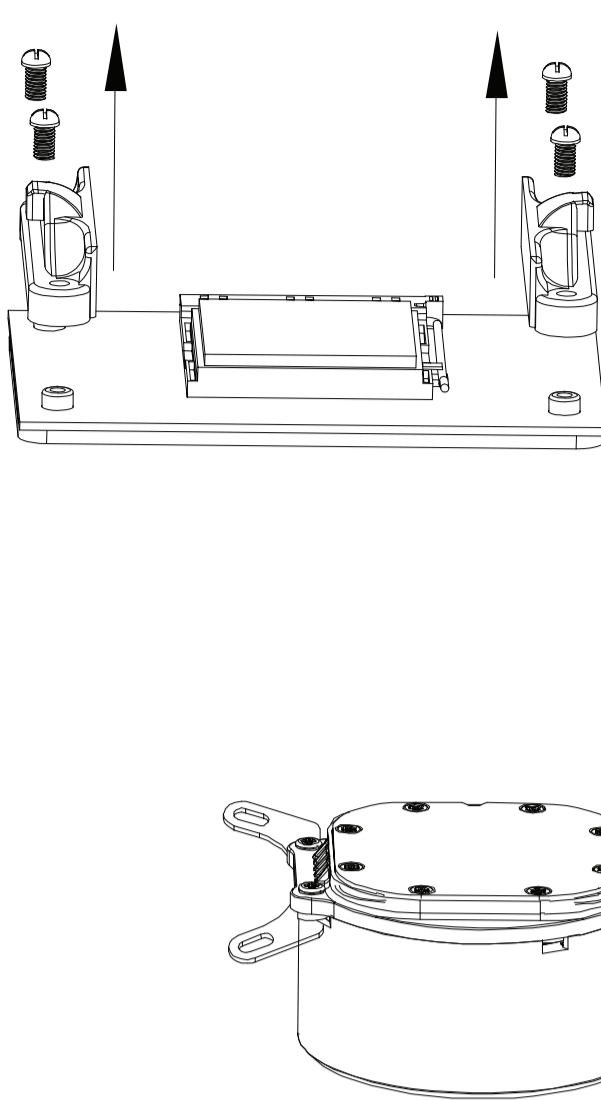

**RO** Pentru instalarea pompei pe o placa de baza cu socket AMD, este necesar sa inlaturati mai intai suportul auxiliar pre-instalat pe socket-ul AMD. Urmati apoi instructiunile pentru montarea pompei.

**EN** For installing the pump on a motherboard with an AMD socket, it is necessary to first remove the pre-installed auxiliary support from the AMD socket. Then follow the instructions for mounting the pump.

**RO** Atasati suportii AMD (K) la pompa folosind suruburile (G) si respectand pozitionarea din imagine.

**EN** Attach the AMD brackets (K) to the pump using the screws (G) and following the positioning in the image.

**Instalarea pompei - AMD**

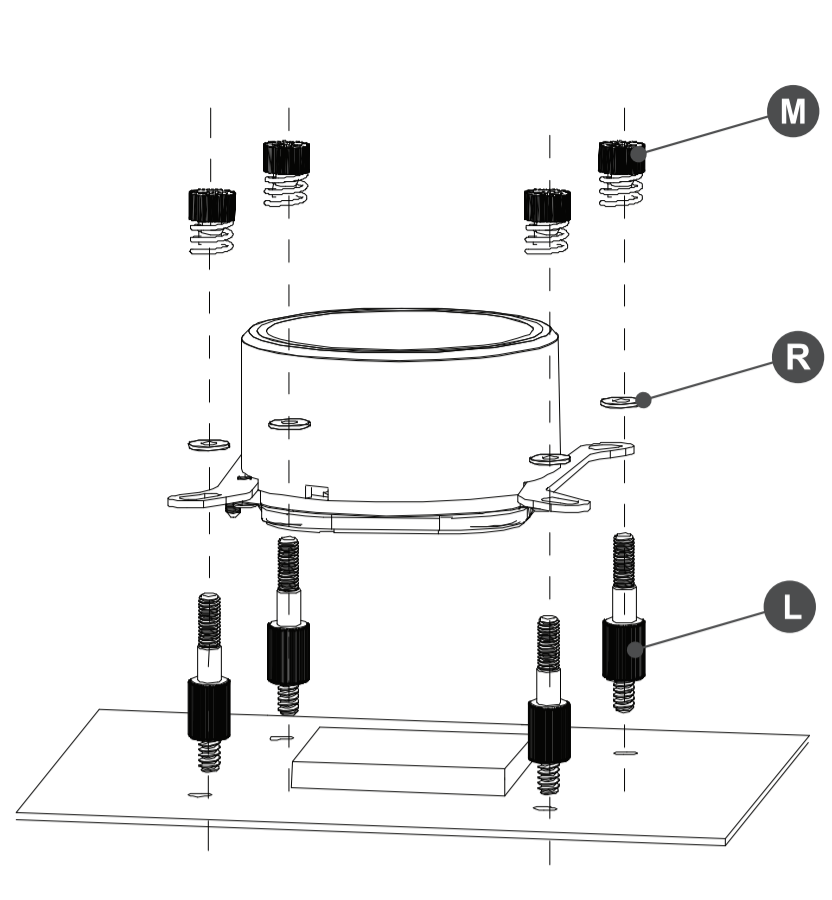

**RO** La instalarea pompei pe o placa de baza AMD, fixati cele patru suruburi (L) in prealabil. Pentru socket AM4, este necesar sa folositi saibe (R) pentru a asigura distanta adecvata intre pompa si procesor. In cazul socket-ului AM5, saibe (R) nu sunt necesare. Strangeti suruburile (M) pe rand si gradual fara a utiliza forta excesiva la final.

**EN** When installing the pump on an AMD motherboard, first attach the four screws (L). For AM4 socket, use washers (R) to maintain proper distance between the pump and the processor. For the AM5 socket, washers (R) are not needed. Tighten the screws (M) gradually, in sequence, without applying excessive force at the end.

**Alimentarea pompei si ventilatoarelor**

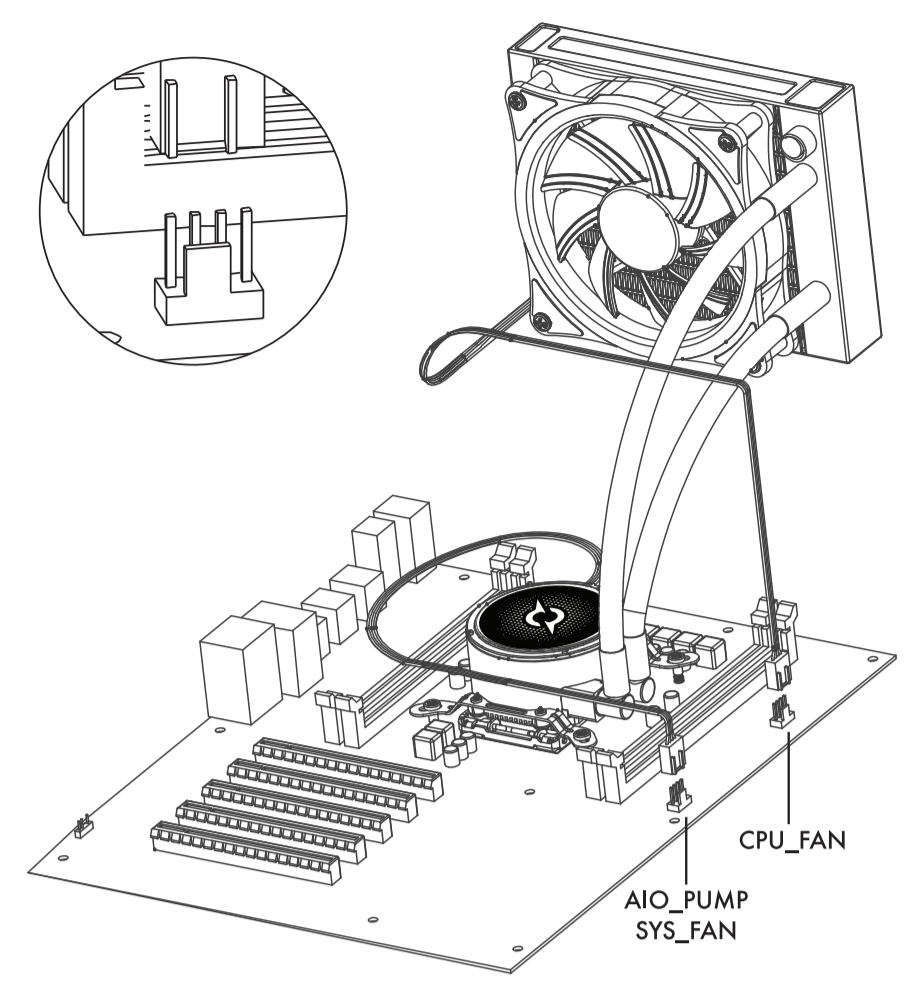

**RO** Conectati cablul 4-pini PWM al pompei la conectorul AIO\_PUMP sau SYS\_FAN de pe placa de baza. Conectati cablul 4-pini PWM al ventilatorului la conectorul CPU\_FAN de pe placa de baza.

**EN** Connect the 4-pin PWM cable of the pump to the AIO\_PUMP or SYS\_FAN connector on the motherboard. Connect the 4-pin PWM cable of the fan to the CPU\_FAN connector on the motherboard.

**Conectarea ventilatoarelor**

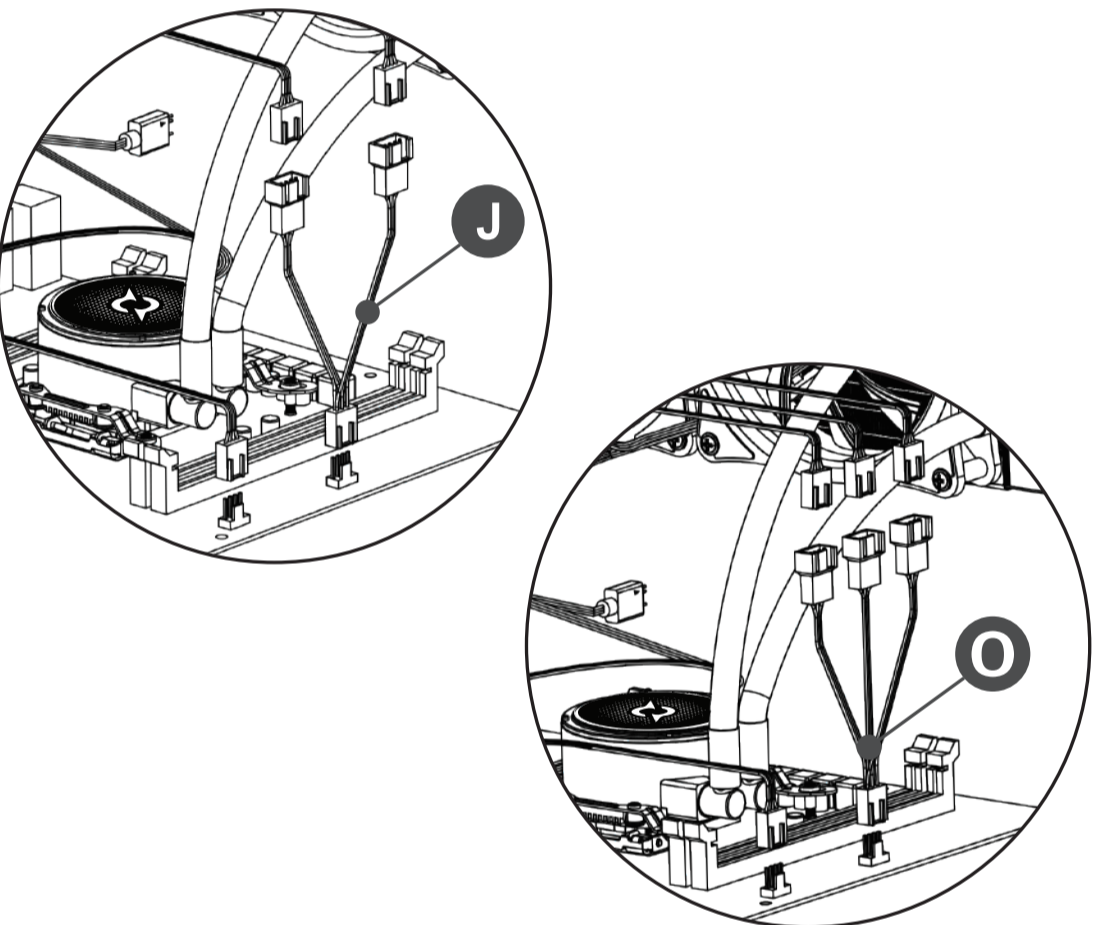

**RO** Pentru modelele cu doua sau trei ventilatoare utilizati cablul PWM adaptor inclus in pachet: (J) pentru doua ventilatoare, (O) pentru trei ventilatoare.

**EN** For models with two or three fans, please use the PWM adapter cable included in the package: (J) for two fans, (O) for three fans.

**Sincronizarea iluminarii**

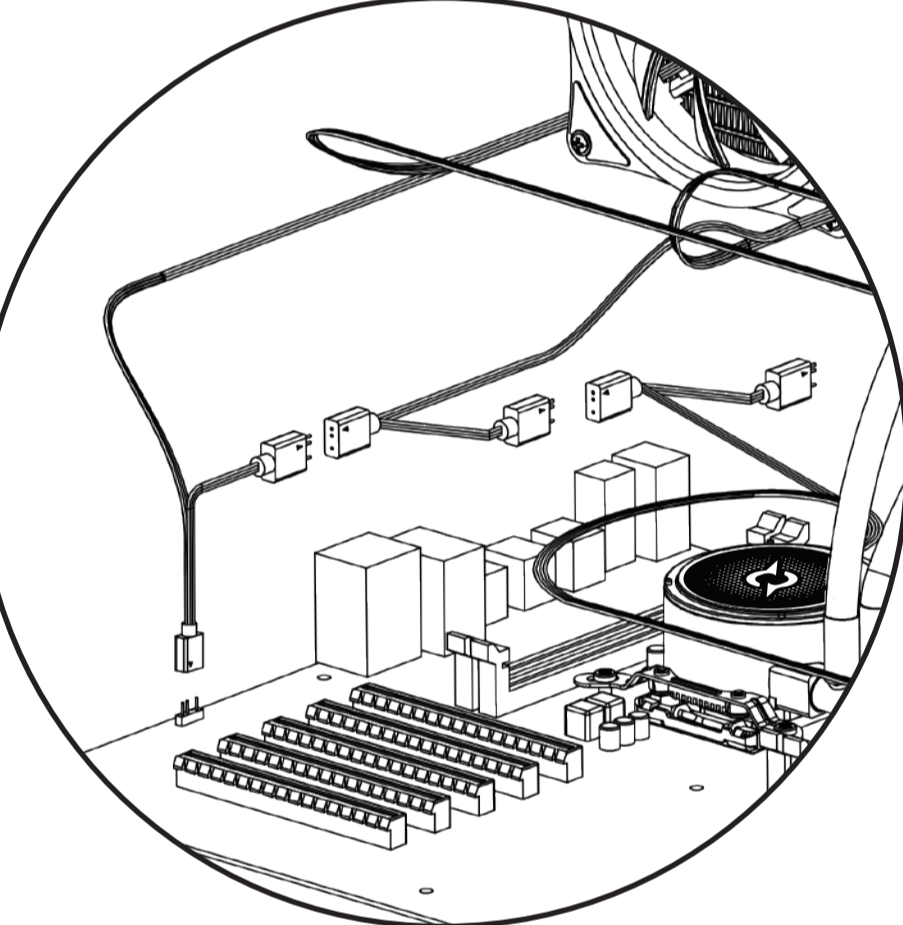

**RO** Pentru controlul si sincronizarea iluminarii prin intermediul placii de baza, inserati cablurile ARGB cu 3-pini ale ventilatoarelor si pompei, respectand imaginea alaturata. Conectati mufa mama 3-pini ARGB ramasa la conectorul ARGB al placii de baza.

**EN** For controlling and synchronizing lighting through the motherboard, insert the 3-pin ARGB cables of the fans and pump, following the adjacent image. Connect the remaining 3-pin ARGB female connector to the motherboard's ARGB connector.

**Controller ARGB**

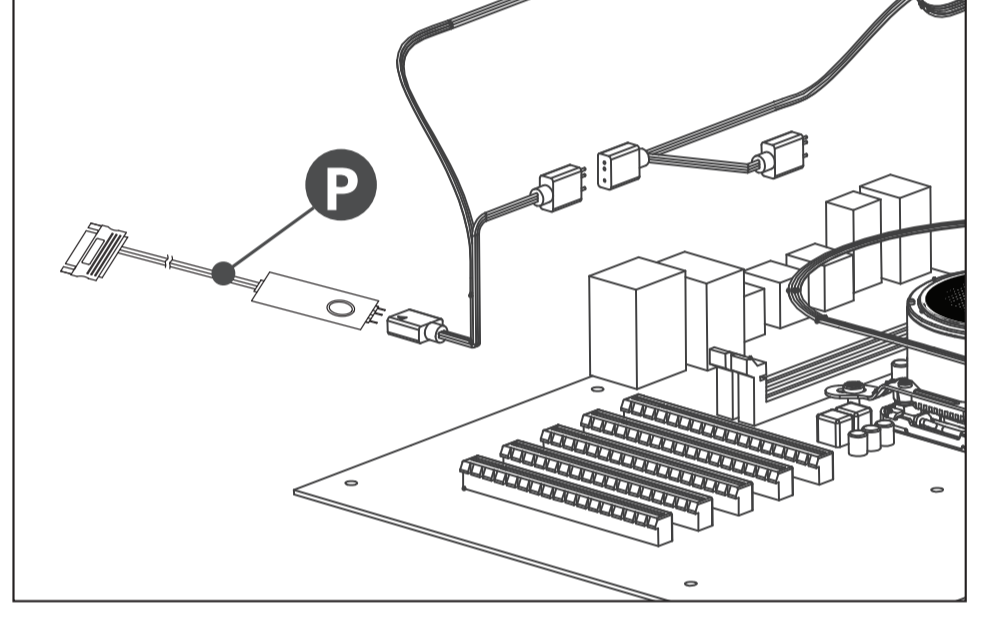

**RO** In cazul in care placa de baza nu este compatibila ARGB, pentru activarea si controlul iluminarii se utilizeaza controller-ul (P) inclus in pachet. Urmati pasii de la sincronizarea iluminarii cu placa de baza, cu diferenta ca la final conectorul mama 3-pini ARGB se conecteaza la controller-ul ARGB extern. Conectati controller-ul ARGB la un conector SATA liber al sursei de alimentare a PC-ului. Efectele de iluminare sunt controlate prin apasarea butonului plasat pe controller-ul ARGB.

**EN** If the motherboard is not ARGB compatible, to activate and control the lighting, the controller (P) included in the package is used. Follow the steps for synchronizing the lighting with the motherboard, but instead, in the end, connect the 3-pin ARGB female connector to the external ARGB controller. Connect the ARGB controller to a free SATA connector from the PC's power supply. The lighting effects are controlled by pressing the button located on the ARGB controller.

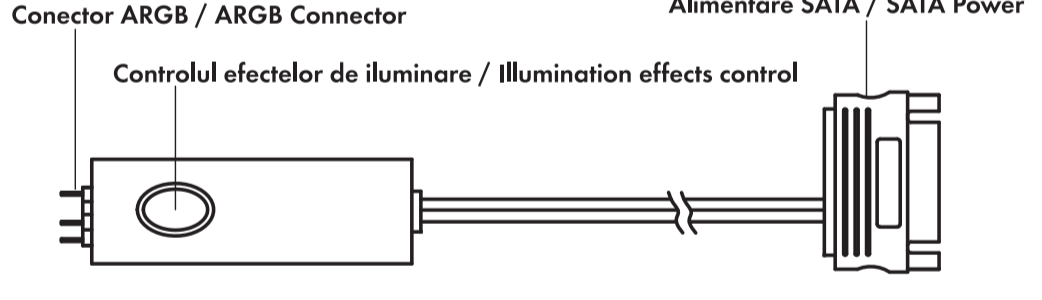

**REGLEMENTARI**

**REGLEMENTARI**

- Unauthorized repairs or disassembly of the product will void the warranty and may cause its damage.  
- This product is safe and complies to EU requirements. (compliant with directive EMC (2014/30/EU))  
- This product is manufactured conforming with the European RoHS standard. (compliant with directive RoHS 2.0 (2015/863/EU))  
- Using the WEEE symbol (the crossed-out bin) indicates that the electrical and electronic equipment inside the package can be recycled. When recycling waste properly, you protect the environment and people health. Segregated household waste collection, aids recycle materials and components used for the production of this device. For detailed information about recycling, please contact your retailer or a local authority.

- Reparările neautorizate sau dezasamblarea produsului duc la anularea garanției și pot cauza deteriorarea lui.  
- Acest produs este sigur, conform cu cerințele UE. (respectivă directiva EMC (2014/30/EU))  
- Acest produs este fabricat în conformitate cu standardul european RoHS. (respectivă directiva RoHS 2.0 (2015/863/EU))  
- Utilizarea simbolului WEEE (pușcă tăvănită cu un X) indică faptul că echipamentele electrice și electronice din interiorul ambalajului pot fi reciclate. Când reciclați deseurile în mod corespunzător protejați mediul înconjurător. Colectarea selectivă ajută la reciclarea materialelor și componentelor folosite la fabricarea acestui echipament. Pentru informații detaliate privind reciclarea, va rugăm să contactați vânzătorul sau autoritățile locale.

- Les réparations non autorisées ou le désassemblage du produit portent à l'annulation de la garantie et peuvent causer son endommagement.  
- Le produit est sûr, conformément aux exigences de l'UE. (respecte la directive EMC (2014/30 / UE))  
- Ce produit est fabriqué conformément à la norme européenne RoHS. (respecte la directive RoHS 2.0 (2015/863/EU))  
- L'utilisation du symbole WEEE (poubelle barrée d'une croix) indique que les équipements électriques et électroniques de l'intérieur de l'emballage peuvent être recyclés. Lorsque vous recyclez correctement les déchets, vous protégez l'environnement. La collecte sélective aide au recyclage des matériaux et des composants utilisés à la fabrication de cet équipement. Pour obtenir des informations détaillées sur le recyclage, veuillez contacter le vendeur ou les autorités locales.

- Nicht autorisierte Reparaturen oder Demontagen des Produkts führen zur Löschung der Garantie und möglicherweise zur Beschädigung des Produktes.  
- Das Produkt ist nach den Anforderungen der EU sicher. (EMV Verordnung (2014/30/UE))  
- Dieses Produkt wird gemäß der europäischen RoHS-Norm hergestellt. (RoHS Verordnung 2.0 (2015/863/EU))  
- Die Verwendung des WEEE-Symbols (mit einem X durchgestrichene Tonne) zeigt an, dass die elektrischen und elektronischen Geräte in der Verpackung recycelt werden können. Wenn Sie Abfälle ordnungsgemäß recyceln, tragen Sie zum Umweltschutz bei. Die Abfalltrennung hilft beim Recycling von Materialien und Bauteilen, die bei der Herstellung dieser Geräte verwendet werden. Ausführliche Informationen zum Recycling erhalten Sie von Ihrem Händler oder den örtlichen Behörden.

- Le riparazioni non autorizzate o lo smontaggio del prodotto portano all'annullamento della garanzia e possono causare il suo danneggiamento.  
- Il prodotto è sicuro, in conformità ai requisiti dell'UE (rispetto la direttiva EMC (2014/30 / UE))  
- Questo prodotto è fabbricato in conformità alla norma europea RoHS. (rispetto la direttiva RoHS 2.0 (2015/863 / UE))  
- L'uso del simbolo WEEE (barra sulla croce) indica che le apparecchiature elettriche ed elettroniche trovate all'interno della confezione possono essere riciclate. Quando riciclate i rifiuti in maniera adeguata, proteggete l'ambiente. La raccolta selettiva aiuta a riciclare i materiali e i componenti utilizzati per la fabbricazione di questo attrezzatura. Per informazioni dettagliate sul riciclaggio, contattate il venditore o le autorità locali.

- Neautorizované opravy alebo demontáž výrobku vedú k zrušeniu záruky a môžu spôsobiť jeho poškodenie.  
- Jedná sa o bezpečný výrobok v súlade s požiadavkami EÚ. (Respektuje smernicu o EMC (2014/30/EU))  
- Tento produkt je vyrobený v súlade s európskou normou RoHS. (splňa smernicu RoHS 2.0 (2015/863 / EU))  
- Použitie symbolu WEEE (odpadkový kôš, ktorý je preškrtnutý s X) naznačuje, že elektrická a elektronická zariadenia z vnútra balenia sú vhodné na recykláciu. Ak riadne recyklujete odpad, chránite životné prostredie. Selektívny zber pomáha recyklovať materiály a komponenty použité pri výrobe tohto zariadenia. Za podrobné informácie o recyklácii, kontaktujte prosím predajcu alebo miestne úrady.

- Нерауторизованне рамонтны работы или разборка прудукта водят до нищожества на гарантацията и могат да доведат до неговата повреда.  
- Продуктът е само една бройка, в съответствие с изискванията на ЕС. (Спазва разпореденията на Директивата EMC (2014/30/EC))  
- Този продукт е произведен в съответствие с европейския стандарт RoHS. (Съответстващата Директива RoHS 2.0 (2015/863/EC))  
- Отбелязването на символа WEEE (зачеркната с X кофа за отпадък) посочва факта, че електрическите и електронните устройства в опаковката могат да се рециклират. Остан анакуливанията на отпадъците помагат за рециклирането на употребяваните материали и съставки за изработване на това устройство. За подробни информации относно рециклирането, молим Ви да се свържете с продавача на устройството или местните власти.

- Nieautoryzowane naprawy lub demontaż produktu spowodują utratę gwarancji i mogą spowodować jego uszkodzenie.  
- Produkt bezpieczny, zgodny z wymogami UE. (przeznaczony dyrektywę EMC (2014/30 / UE))  
- Ten produkt został wyprodukowany zgodnie z europejską normą RoHS. (odpowiednio dyrektywę RoHS 2.0 (2015/863 / EU))  
- Użycie symbolu WEEE (kosz na śmieci z X) oznacza, że sprzęt elektryczny i elektroniczny wewnątrz opakowania można poddać recyklingowi. Poprzez prawidłowy recykling odpadów chronisz środowisko. Selektowna zbiórka pomaga w recyklingu materiałów i komponentów użytych do produkcji tego sprzętu. Aby uzyskać dodatkowe informacje dotyczące recyklingu, skontaktuj się ze sprzedawcą lub lokalnymi władzami.  
- A termék nem szakszerű javítása vagy a termék alkatrészeire való bontása a garancia eltérését jelenti és ugyanakkor a termék sérülését is előidézhethet.

- A termék biztonságos, gyártása EU-s normáknak megfelelő. (EMC/2014/30/EU)  
- A termék gyártása az európai RoHS standard normalitáknak megfelelő. (RoHS 2.0 (2015/863/EU))  
- A WEEE szimbólum (hátrított kukorika szimbólum) jelzi, hogy a csomagban található elektromos és elektronikus alkatrészek újrahasznosíthatók. A hulladék megfelelő újrahasznosításával védi környezetét. A selektív hulladékgyűjtéssel hozzájárul ezen igények kielégítéséhez használt anyagok és alkatrészek újrahasznosításához. Bővebb tájékoztatást kérjünk igényelje a forgalmazótól vagy a helyhatósági szervek képviselőitől.

**REGLEMENTARI**

**REGLEMENTARI**

- Neoprávné opravy alebo demontáž výrobku vedú k zrušeniu záruky a môžu spôsobiť jeho poškodenie.  
- Jedná sa o bezpečný výrobok v súlade s požiadavkami EÚ. (Respektuje smernicu o EMC (2014/30/EU))  
- Tento produkt je vyrobený v súlade s európskou normou RoHS. (splňa smernicu RoHS 2.0 (2015/863 / EU))  
- Použitie symbolu WEEE (odpadkový kôš, ktorý je preškrtnutý s X) naznačuje, že elektrická a elektronická zariadenia z vnútra balenia sú vhodné na recykláciu. Ak riadne recyklujete odpad, chránite životné prostredie. Selektívny zber pomáha recyklovať materiály a komponenty použité pri výrobe tohto zariadenia. Za podrobné informácie o recyklácii, kontaktujte prosím predajcu alebo miestne úrady.

- Неавторизованне рамонтны работы или разборка прудукта водят до нищожества на гарантацията и могат да доведат до неговата повреда.  
- Продуктът е само една бройка, в съответствие с изискванията на ЕС. (Спазва разпореденията на Директивата EMC (2014/30/EC))  
- Този продукт е произведен в съответствие с европейския стандарт RoHS. (Съответстващата Директива RoHS 2.0 (2015/863/EC))  
- Отбелязването на символа WEEE (зачеркната с X кофа за отпадък) посочва факта, че електрическите и електронните устройства в опаковката могат да се рециклират. Остан анакуливанията на отпадъците помагат за рециклирането на употребяваните материали и съставки за изработване на това устройство. За подробни информации относно рециклирането, молим Ви да се свържете с продавача на устройството или местните власти.

- Nieautoryzowane naprawy lub demontaż produktu spowodują utratę gwarancji i mogą spowodować jego uszkodzenie.  
- Produkt bezpieczny, zgodny z wymogami UE. (przeznaczony dyrektywę EMC (2014/30 / UE))  
- Ten produkt został wyprodukowany zgodnie z europejską normą RoHS. (odpowiednio dyrektywę RoHS 2.0 (2015/863 / EU))  
- Użycie symbolu WEEE (kosz na śmieci z X) oznacza, że sprzęt elektryczny i elektroniczny wewnątrz opakowania można poddać recyklingowi. Poprzez prawidłowy recykling odpadów chronisz środowisko. Selektowna zbiórka pomaga w recyklingu materiałów i komponentów użytych do produkcji tego sprzętu. Aby uzyskać dodatkowe informacje dotyczące recyklingu, skontaktuj się ze sprzedawcą lub lokalnymi władzami.  
- A termék nem szakszerű javítása vagy a termék alkatrészeire való bontása a garancia eltérését jelenti és ugyanakkor a termék sérülését is előidézhethet.

**SUPPORT**

**SUPPORT**

**RO** Daca intampinati erori sau orice alte probleme in utilizarea produsului nu ezitati sa ne contactati.

Disclaimer:  
Pentru a asigura exactitatea tuturor informatiilor furnizate in acest document au fost luate toate masurile necesare. PC-coolers SRL nu isi asuma nicio raspundere, expresă sau implicată, pentru orice deteriorare a componentelor sistemului sau a altor dispozitive ca urmare a oricărei greșeli sau omisiuni în timpul instalării sau îndepărtării echipamentului sau din cauza oricărei defect sau disfuncționare a produsului în sine.

**EN** If you encounter errors or any other problems with the product don't hesitate to contact us.

Disclaimer:  
All efforts have been made to ensure accuracy of all information provided in this document. PC-coolers SRL assumes no liability, expressed or implied, for any damage(s) occurring to your system's components or other devices as a result of any mistake or omission during equipment installation or removal, or due to any defect or failure of the product itself.

**support@aqirys.com**



SCAN ME (product page)

SCAN ME (Follow us)